



INSTALLATION GUIDE

WaterBridge Wall-Mounted Exposed Showers 800 Series

Nov 2023

WaterBridge Exposed Showers are available in four standard wall-mounted configurations:

- | | |
|-------------------|---|
| WB-SHW-840 | Rain head only |
| WB-SHW-850 | Rain head and handshower |
| WB-SHW-870 | Rain head and tub filler / foot wash |
| WB-SHW-880 | Rain head, handshower, and tub filler / foot wash |

Custom showers are available by special order. Please contact Sonoma Forge for more info.

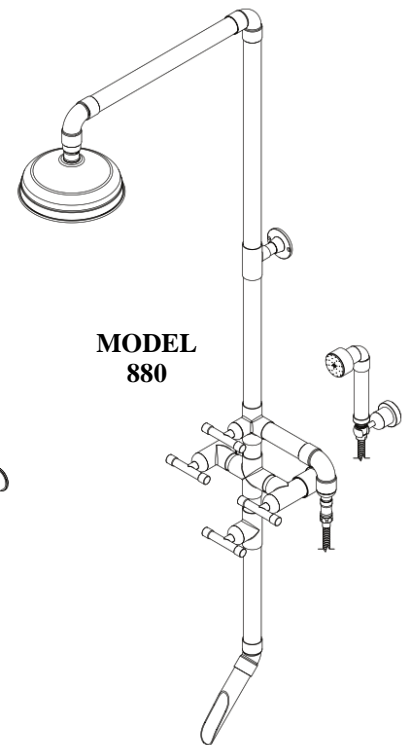
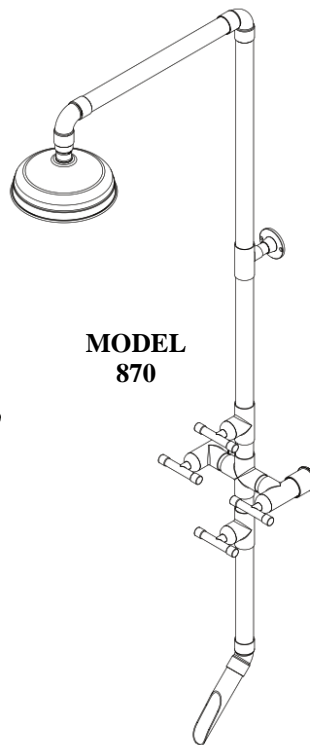
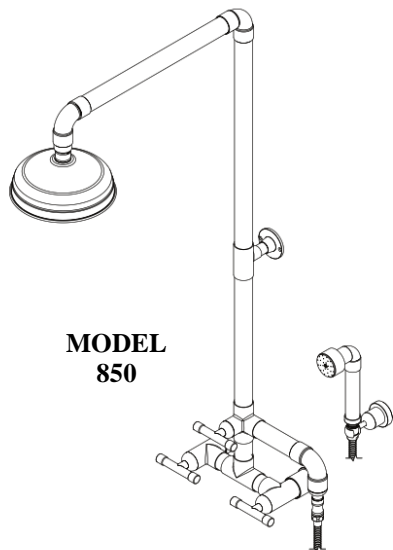
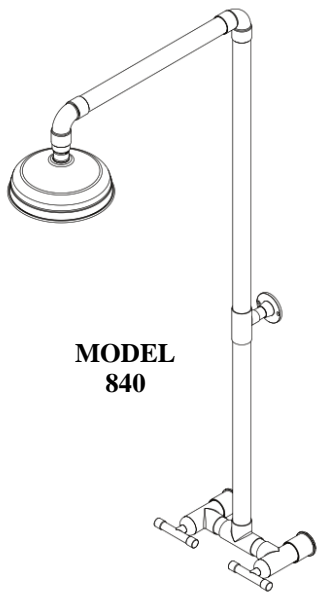

**It is strongly recommended that this, and all fixtures,
be installed by a professional plumber.**



INSTALLATION GUIDE

WaterBridge Wall-Mounted Exposed Showers 800 Series

Nov 2023

Some state plumbing codes require the use of a **remote anti-scald thermostatic mixing valve**. This valve may be installed anywhere between the uninterrupted hot water supply and fixture.

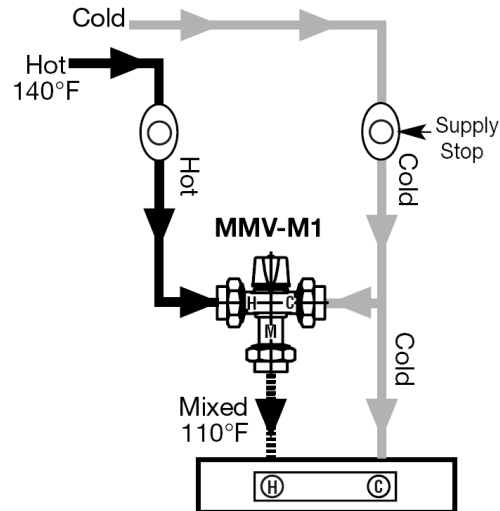

Example of Watts MMV-1 (not included)

Remote Anti-Scald Valve Installation:

Prior to installing this valve, make sure that all lines have been flushed of any debris. The hot and cold water must be fully operational at the valve inlets or the unit will not function properly even during testing or flushing.

Close both the hot and cold water supply shut-off valves and bleed the remaining water from the system.

Clean pipe ends and solder both the hot and the cold connections at the locations locate on the valve body. The valve cartridges do not have to be removed before soldering.

After soldering, check for leaks.

Note: When using with a recirculation system, re-circulated water must enter downstream to the thermostatic system.

WARNING: Temperatures exceeding 110 degrees are dangerous and may cause scalding, server injury or death. This valve is NOT factory preset. Installer must make the proper adjustments.



INSTALLATION GUIDE

WaterBridge Wall-Mounted Exposed Showers 800 Series

Nov 2023

Waterbridge Exposed Showers are plumbed to 1/2" copper lines.
The Shower employs compression fittings to attach to the lines that have been stubbed out 8" on center.

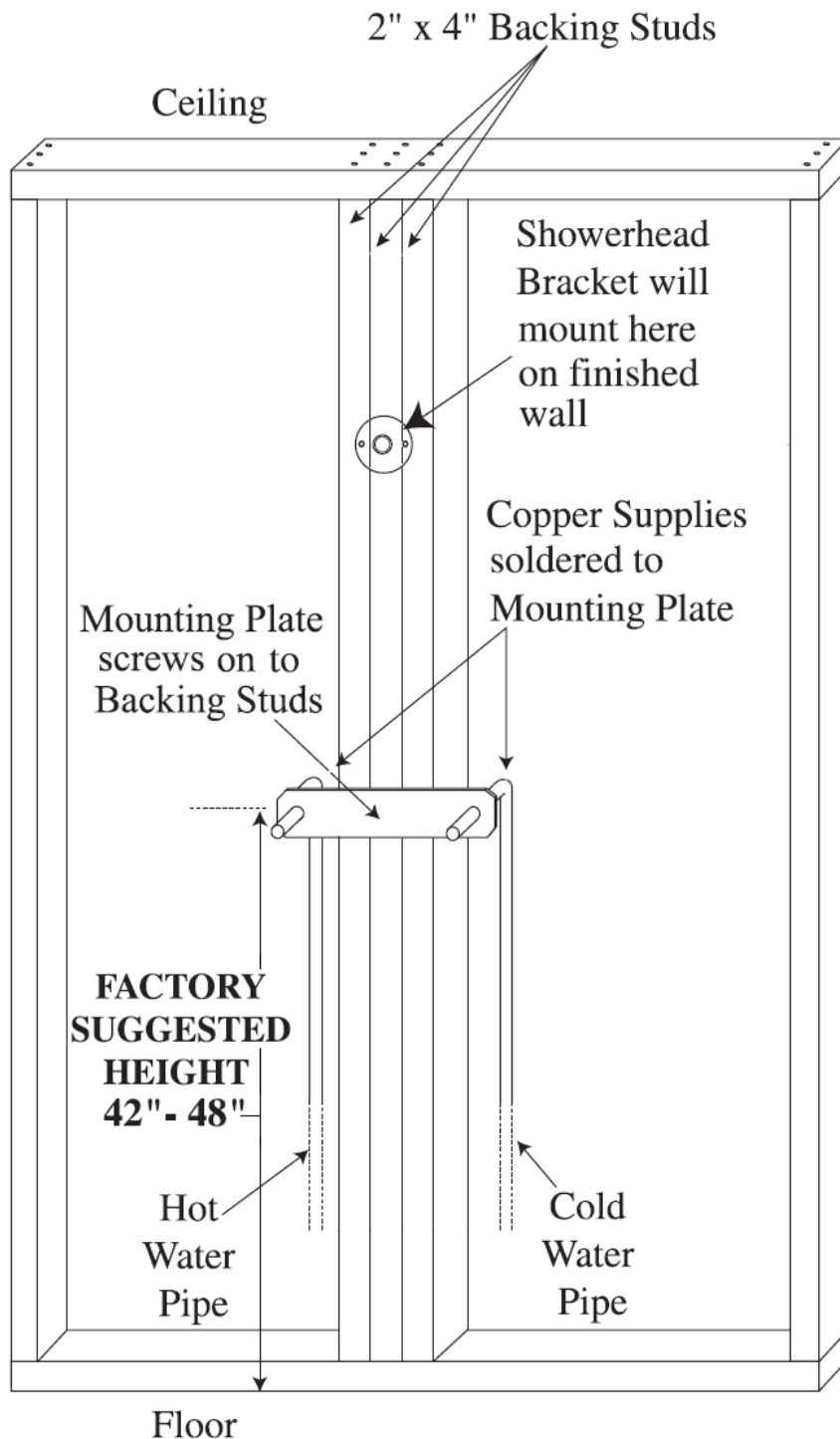



Nov 2023

Shower Body Installation

- 1) Determine a height for the rain head. The face of the rain head is 36" from the center of the controls.
- 2) Install a **copper template** like the one pictured below (not included with shower). Additional framing should be installed into the wall behind the mounting plate for support.



- 3) Run 1/2" copper tube through the template and solder in place. Allow for at least 2-1/2" stubbed out of the finished wall. Cap lines until ready to install trim.
- 4) Remove the backplate from the shower valve body by unscrewing the compression nuts. Take care not to damage or misplace the ferrules.
- 5) Uncap the supply lines, and cut them down to 1-1/16" to 1-9/16" from the finished wall.
- 6) Slide the shower backplate over the lines, and screw firmly to the wall.
Care should be used to properly level the back plate, as this will align the entire shower.
- 7) Install the ferrules over the supply lines.





INSTALLATION GUIDE

WaterBridge Wall-Mounted Exposed Showers 800 Series

Nov 2023

- 8) Place shower body against the wall plate so that it aligns properly to the compression nuts. It is recommend to use Teflon tape or joint compound on the threads.

**For Shower Models (870 & 880) with Tub Filler/Foot Wash;
Install the spout and optional extension prior to installation the shower on the wall.**

- 9) Tighten the compression nuts, being careful not to damage the finish.
- 10) Using a level, the upper mounting bracket should now be attached to the wall using the supplied screws.

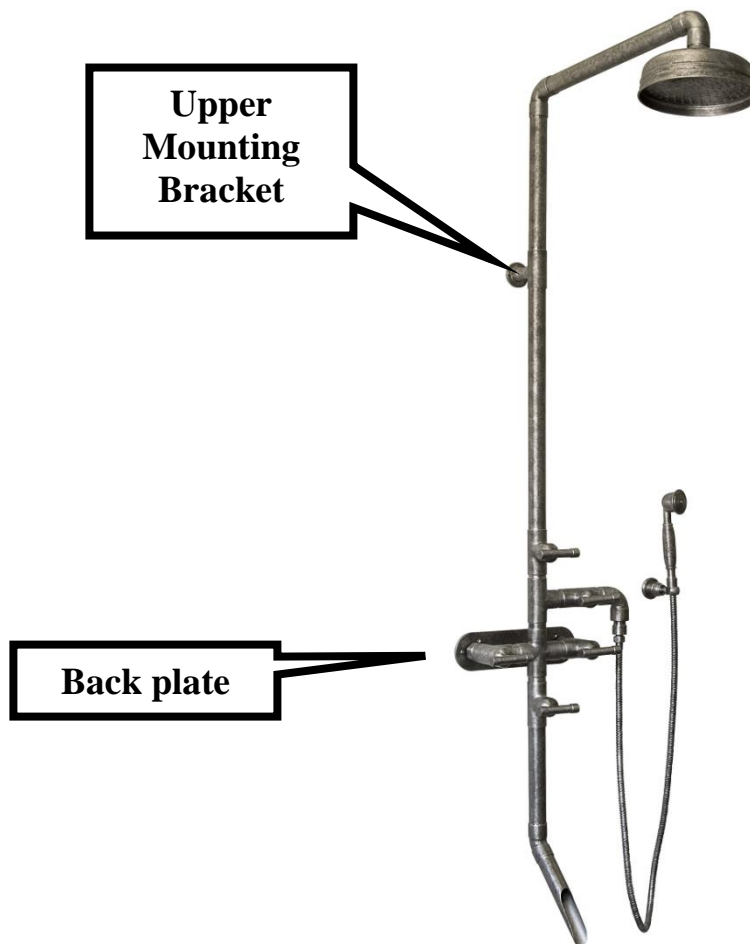

- 11) For **Models 850 & 880**, a separate wall bracket is included for the hand wand. Remove the internal mounting bracket from the back by loosening the set screw. Mount the bracket on the wall with provided hardware. Affix the wall bracket with set screw pointing down, then tighten set screw.

Ensure that the hose does not have any negative tension when not in use, as it will unravel over time.



INSTALLATION GUIDE

WaterBridge Wall-Mounted Exposed Showers 800 Series

Nov 2023

12) Once the shower body is installed, the shower arm should be installed. Teflon tape **must** be used on the threads.

13) Then the Rain Head should be installed:
(again, employing Teflon tape)

- a) Unscrew the collar from the top of the rain head.
- b) Using a 5/16" Allen wrench (not provided), thread the ball joint through the collar and into the shower arm until secure.
- c) Supporting the head, tighten the collar back on to the top of the head.

Note: The shower head is shipped with a flow restrictor inside the ball joint. Removing this will cause damage.



Ball joint with Allen wrench

14) Turn water supply on and check for leaks.

15) Check volume controls and shut-off valves for proper function.

Care & Maintenance: No abrasives should be used to clean Sonoma Forge products. Mild soap and water can be used, and 100% carnauba wax to protect the finish.

All exterior plumbing must be drained if freezing temperatures are expected.