

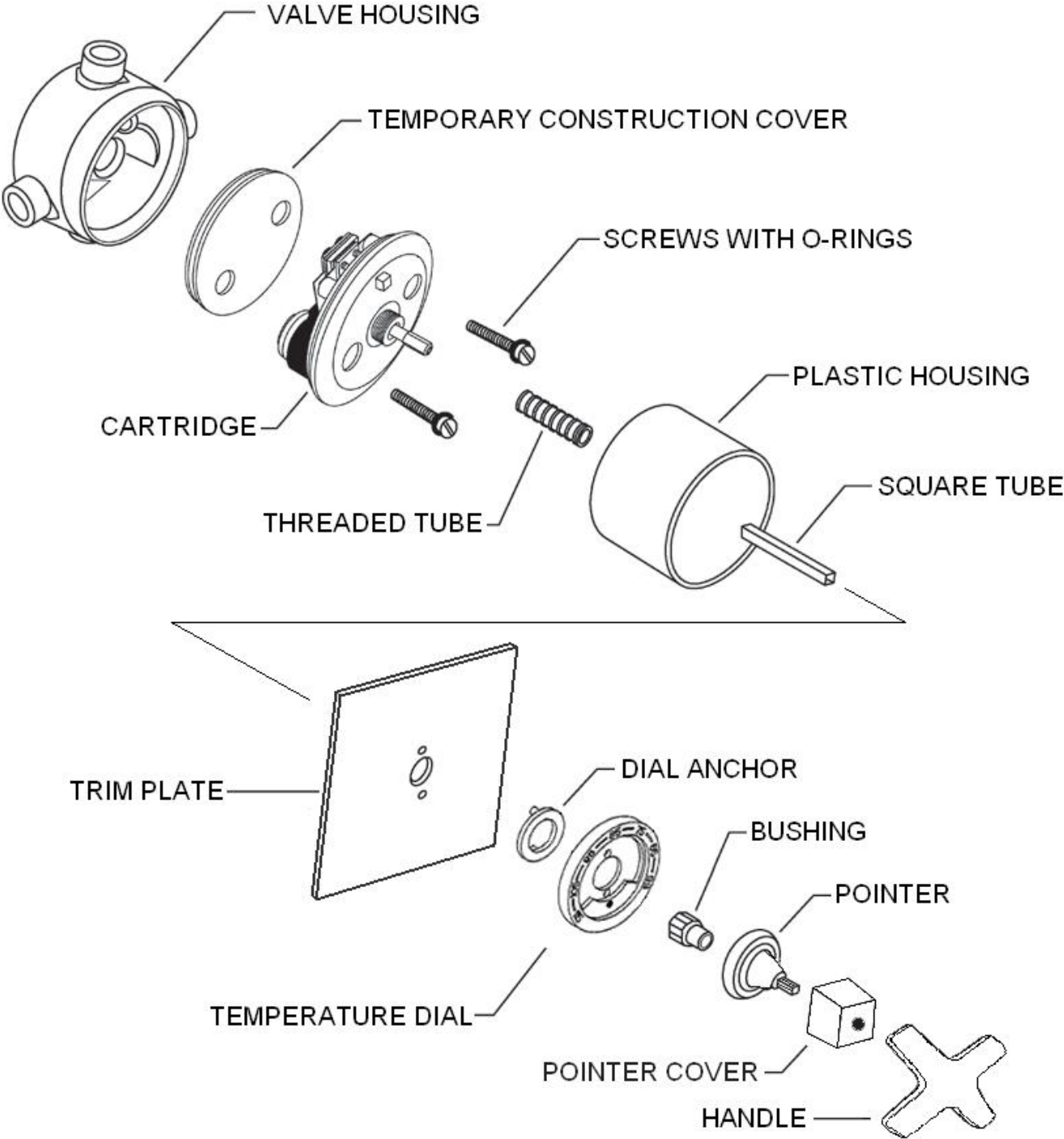

UPDATED  
VERSION  
JAN 2012

# INSTALLATION GUIDE C1XX 3/4" THERMOSTATIC CONTROL





UPDATED  
VERSION  
JAN 2012

## **INSTALLATION GUIDE** **CIXX 3/4" THERMOSTATIC CONTROL**

- 1. The valve should be installed with the center of the inlets at 1-5/8" to 3" inside of the finished wall.  
Extension kits are available if valve is installed too far in wall.**
- 2. Cut the Plastic Housing so that it is flush with the finished wall.**
- 3. Flush the lines completely.**
- 4. Remove & Discard the Temporary Construction Cover, retaining the two screws and o-rings.**
- 5. Install the Cartridge, and secure it, reusing the two screws and o-rings.**
- 6. Fit the Threaded Tube onto the Cartridge & tighten.**
- 7. Place the Trim Plate, Dial Anchor, and Dial onto the Threaded Tube.  
The Plate should be positioned with the two small holes above/below the center hole.**
- 8. Make a cutting mark on the Threaded Tube 1/4" from the Dial's face.  
Remove the tube, cut it, and de-burr the edges carefully.**
- 9. Replace and tighten the Threaded Tube onto Cartridge.  
For an added watertight seal, a bead of clear silicone caulk may be applied to the back of the Cover Trim Plate after final preparations are complete.**
- 10. Secure the Bushing onto the Threaded Tube (this also holds the Cover Trim Plate to the Cartridge)**
- 11. Slide the Square Tube completely through the Bushing, onto the Cartridge.**
- 12. Make a cutting mark on the Square Tube where it flushes with the Bushing.**
- 13. Remove the Square Tube, Cut it, de-burr the edge, and replace.**
- 14. Follow instruction guide that came with valve to calibrate temperature.**
- 15. Place the Pointer onto the Bushing & secure with set screw.**
- 16. Install Pointer Cover over Pointer and secure with set screw.**
- 17. Fit Handle onto Pointer stem & secure with set screw.  
Set screws not pictured.**