

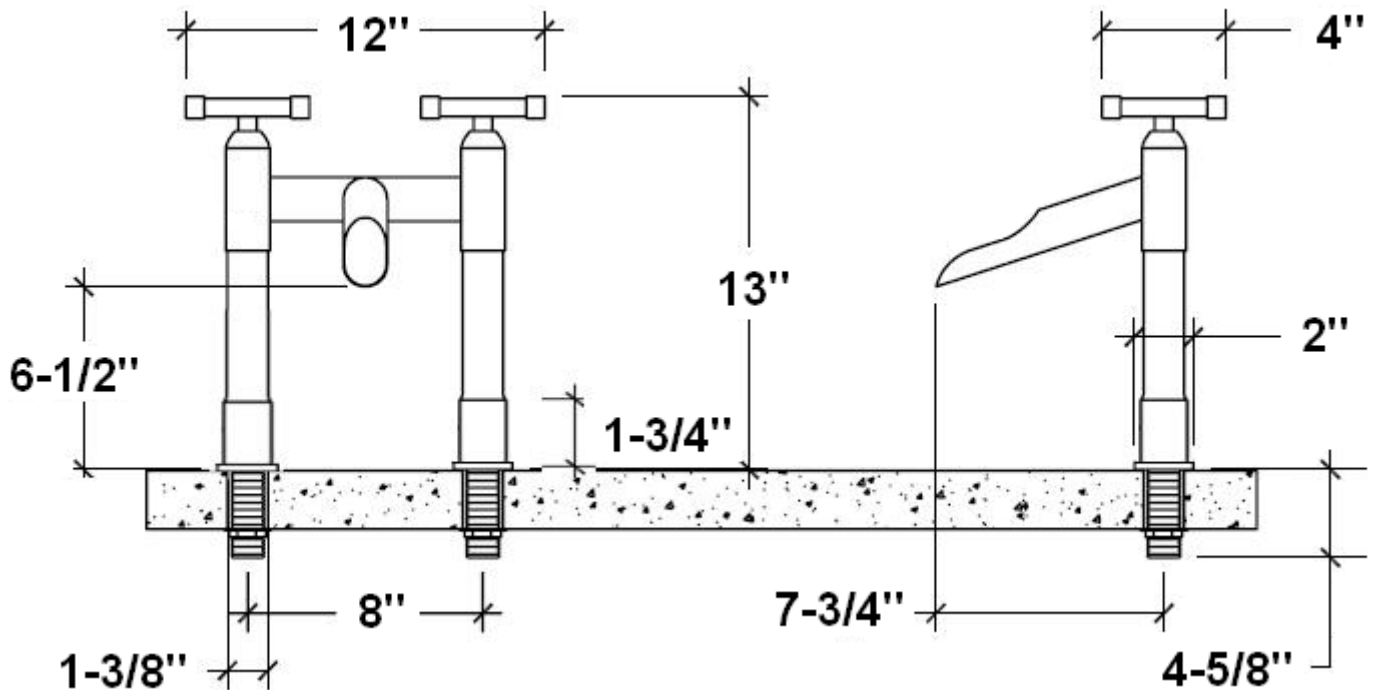

PRODUCT SPECIFICATIONS

WATERBRIDGE ROMAN TUB FILLER - DECK MOUNT (WB RTF DM)



FACTS

3/4" Quarter-turn Ceramic Cartridges, 10 GPM (depending on water pressure)

Legs 8" on center (Leg on hot side is insulated)

Holes should be drilled at 1-1/8" to 1-1/4" (2" Trim rings cover gaps)

Plumber supplies Sweat Adapter (straight or elbow). Rough must be rigid.

3/4" NPS connection for mounting (1" O.D.) – compression fitting

IAPMO Approved

Available in Four Standard Finishes (WaterBridge Collection)

Rustic Copper (RC) Oil Rubbed Bronze (ORB)

Rustic Nickel (RN) Pizzazz Nickel (PN)

Stabilizer Tee available in matching finishes as an accessory.



UPDATED
VERSION
JUN 2009

INSTALLATION DETAILS WATERBRIDGE ROMAN TUB FILLER

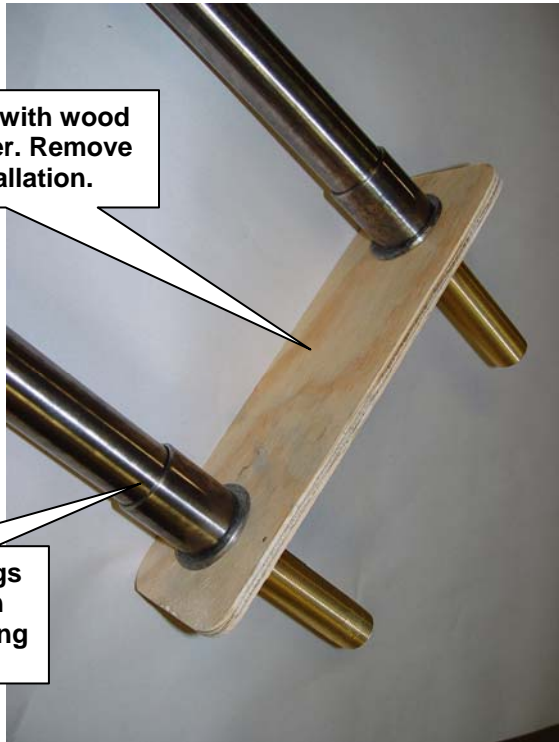

Legs shipped with wood or metal spacer. Remove before installation.

Shipped with o-rings to keep sleeves in place. Remove during installation.

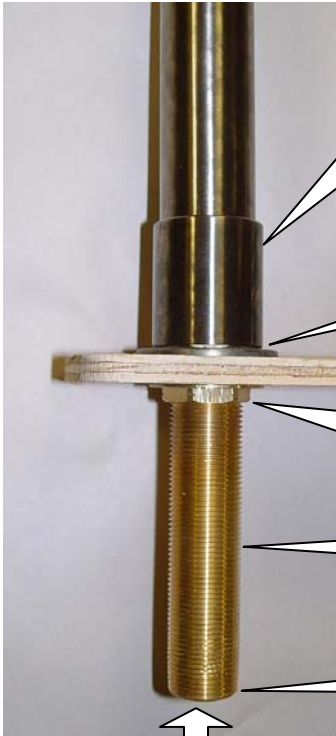

Leg Trim Sleeve
(Hides Compression Nut)

2" Trim Ring
(Hides hole through floor)

Retaining Nut
(Optional - Holds Faucet tight against floor)

3/4" Nipple

Water Supply

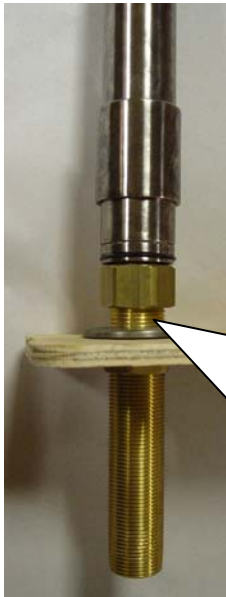

3/4" Nipple should be installed exactly 5/8" above finished floor for optimum compression seal

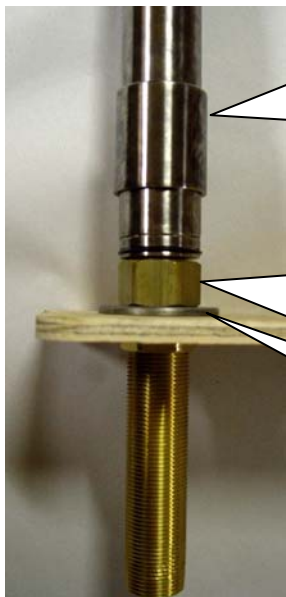

Lift Trim Sleeve to expose compression fitting nut

Tighten down compression fitting locking nut – then slide Trim Sleeve down to hide nut

Trim Ring